

40-series Metal Kadee® Couplers for body mounting

#41

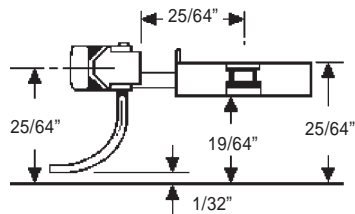

LONG
UNDERSET
SHANK

#42

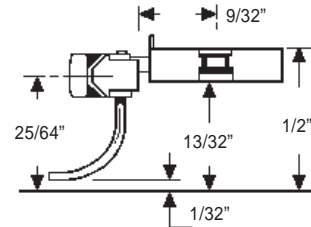

MEDIUM
OVERSET
SHANK

#43

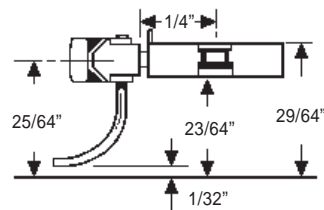

SHORT
CENTERSET
SHANK

#44

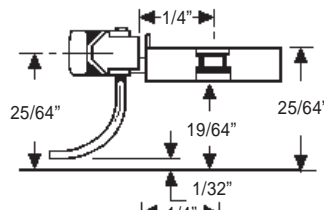

SHORT
UNDERSET
SHANK

#45

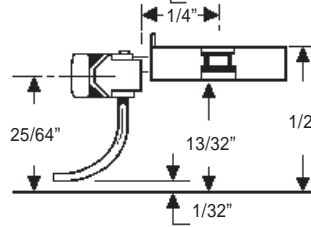

SHORT
OVERSET
SHANK

#46

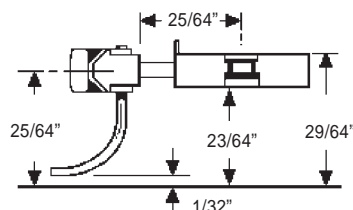

LONG
CENTERSET
SHANK

#47

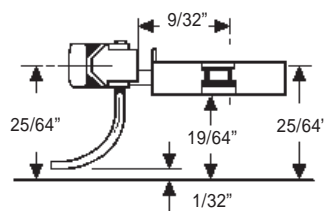

MEDIUM
UNDERSET
SHANK

#5

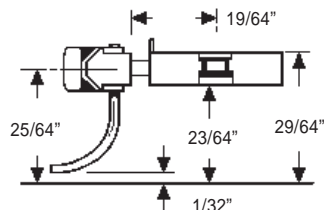

MEDIUM
CENTERSET
SHANK

#49

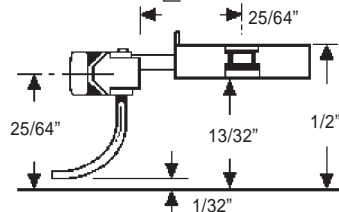

LONG
OVERSET
SHANK

METAL MEANS STRENGTH YOU CAN COUNT ON FOR YOUR LONG HAUL!

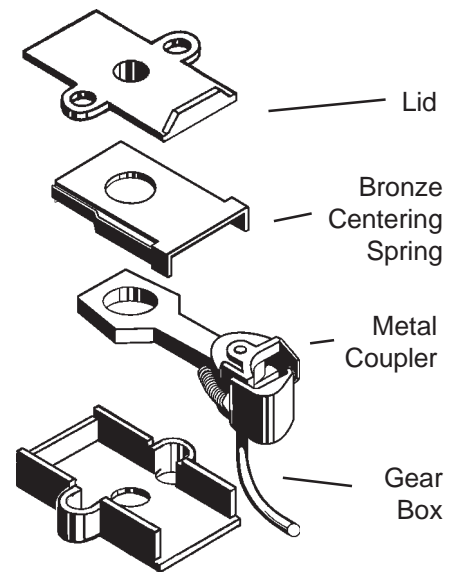

Mounting with supplied gear box

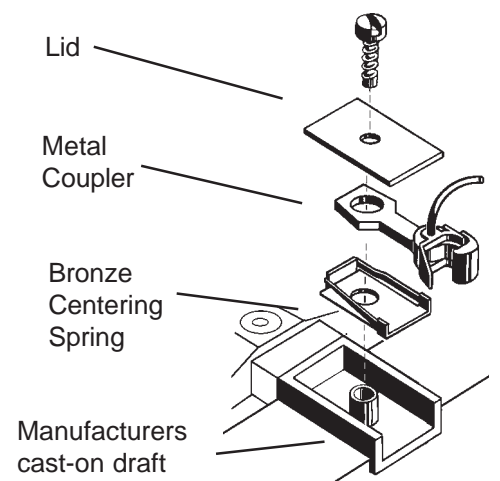

Inverted
Mounting with cast-on coupler pockets

40 Series metal couplers



The 40 Series Couplers are metal equivalents to the offset shank 20 and 30 Series Couplers and have the same dimensions as their corresponding coupler numbers, such as the #47 is the same as the #27 and #37 Couplers. These were developed to provide the modeler a metal offset series of couplers to complement the #5 Coupler. In the series there is no #48 Medium Centerset Coupler for this is the #5 (which is the equivalent to the #28/#38 Couplers).

Although the 20 and 30 Series Couplers are made of very strong plastic many modelers like to use only metal couplers which of course are stronger. The strength of metal couplers over plastic sometimes is only a matter of personal choice and not the particular application, however there is most certainly many reasons to use metal couplers when the extra strength is needed.

The 40 Series Couplers come with a #5 type of centering spring and an insulated draft gear box. The #43, #44 and #45 short shanked couplers come with a draft gear box designed to accommodate the shorter shank.

It is not recommended to use a metal coupler directly on a metal surface or in a metal draft gear box to avoid the possible electrical crossover or shorting that may cause damage. Use the provided insulated draft gear box or the appropriate insulated plastic 20 or 30 Series Couplers.

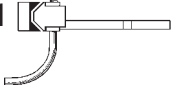
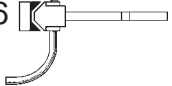
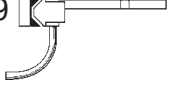
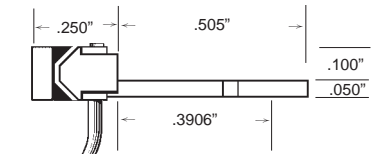
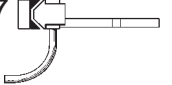
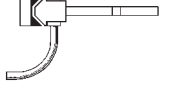
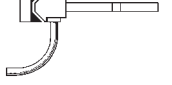
The #5,20,30,40 Series Couplers are interchangeable into each others draft gear boxes. Thus if our coupler conversion list recommends a #27 Coupler then a #47 can be used. However, you may need to use the components or draft gear box from the 20 or 30 Series Couplers for that particular conversion when interchanging with the 40 Series Couplers.

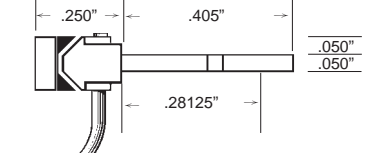
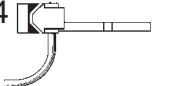
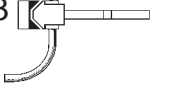
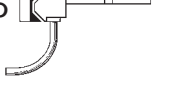
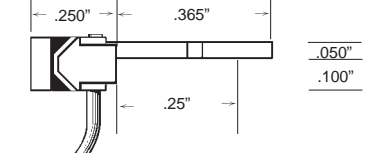
<p>#21 #31 #41 </p> <p>#26 #36 #46 </p> <p>#29 #39 #49 </p>	<p>Long underset shank raises knuckle height</p> <p>Long centerset shank knuckle is centered</p> <p>Long overset shank lowers knuckle height</p>	 <p style="text-align: center;">Long Underset Shank</p>
<p>#27 #37 #47 </p> <p>#3 #9 #5 </p> <p>#28 #38 </p> <p>#22 #32 #42 </p>	<p>Medium underset shank raises knuckle height</p> <p>Medium metal centerset shank knuckle is centered (#10 & #11 pack)</p> <p>Medium plastic centerset shank (same as #5)</p> <p>Medium overset shank lowers knuckle height</p>	 <p style="text-align: center;">Medium Centerset Shank</p>
<p>#24 #34 #44 </p> <p>#23 #33 #43 </p> <p>#25 #35 #45 </p>	<p>Short underset shank raises knuckle height</p> <p>Short centerset shank knuckle is centered</p> <p>Short overset shank lowers knuckle height</p>	 <p style="text-align: center;">Short Overset Shank</p>