

# MODEL POWER

# 250 TON CRANE

## #36 BODY MOUNTED COUPLER CONVERSION

1. Remove the truck from the underbody.
2. Cut the truck mounted coupler box forward of the truck bolster crossbrace and remove the remaining ridge on top of the crossbrace on cars equipped with this type of Talgo truck. On cars equipped with a Talgo clip, rather than a cast-on box for coupler mounting, simply remove clip from truck.
3. Drill and tap a 2-56 coupler mounting hole exactly in the center, 1/4" from edge and on centerline of loco frame
4. Slip coupler through opening and assemble the #36 coupler with the coupler on bottom and the Torsion Spring on the top. Use a 2-56 screw of appropriate length to secure the coupler.
5. Replace the truck from the underbody.
6. Check for correct coupler height, function, and clearance and make any adjustments necessary.

031504

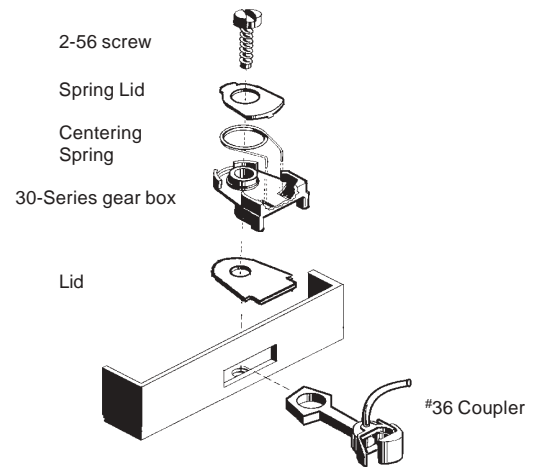

**Fig.1**

**#36 Installation**