

BACHMANN

EMD F-45

#37 COUPLER CONVERSION

1. Remove body shell and coupler from the chassis.
2. Carefully remove the side walls (shaded portion) of the coupler pocket flush with the coupler mounting surface, see Fig.1. Drill through the second hole (A), located approximately 1/8" from the front hole (B), with a #50 drill and tap hole for 2-56 threads. See Fig.2.
3. The locomotive pilot coupler opening bottom edge should be carefully filed down enough to allow the coupler assembly to enter.
4. Assemble the #37 Coupler with the coupler on top and the Torsion Spring on the bottom. Do not use the coupler lid. See Fig.2.
5. Align and secure coupler with 2-56 screw.
6. Check for correct coupler height, function, and clearance and make any adjustments necessary.

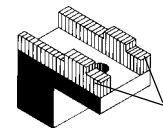
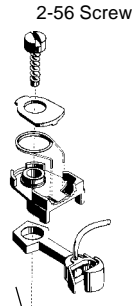

Fig.1

Cut away side walls flush with coupler mounting surface and file smooth and flat



#37 Coupler assembly

Drill and tap 2-56 hole

Modified coupler mounting platform

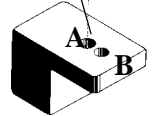

Fig.2
#37 Installation