

## REPLACEMENT COUPLER



**#1-Scale  
Medium Offset Coupler  
1838**



**#1-Scale  
Large Offset Coupler  
1839**



**#1-Scale  
Centerset/Reverse  
Offset Coupler  
1840**



**G-Scale  
Centerset Coupler  
1850**

With the exception of the gear box lid included with the #1838 coupler, these replacement couplers use the same gear box, gear box lid and centering springs.

Couplers will fit into the following Draft Gear box styles.

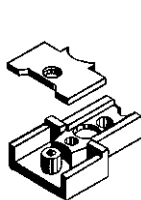

#831/1831 type  
Truck Mount Gear Box

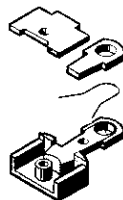

#832/1832 type  
Swinging Gear Box

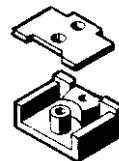

#835/1835 type  
Short Gear Box

### COUPLER OPERATION TO COUPLE -

Simply push cars together until knuckles bypass each other and lock into position.

### FOR DELAYED UNCOUPLING -

1) Stop with the couplers over an uncoupler and back up slightly with the couplers still over the uncoupler, allowing slack to occur between couplers. 2) Pull forward slightly. Couplers are now in the delayed position. 3) Back up, pushing the car(s) to the desired location. Do not permit slack to develop between couplers. 4) Pull forward, leaving the car(s) where desired. Couplers automatically return to normal coupling position.

Use Kadee® Grease-em, the dry lubricant recommended for use with all Kadee® Magne-Matic® couplers. Grease-em will not attract the dirt and dust that gums up the inside of couplers like oil, grease or other lubricants will. Use our #829 #1-Scale or #880 G-Scale Height Gauge to check for the correct coupler height and trip pin clearance. The N.M.R.A. standard for coupler height is the centerline of coupler is 1 1/16" (1.0625") for #1-Scale & 1 1/8" (1.125") G-Scale.

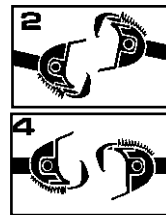
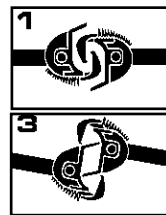

NOTE: If couplers swing open too far when uncoupling, lower magnet slightly to correct.

Note: We include extra knuckle springs. The Replacement Knuckle Spring used on Kadee® #1-Scale couplers are sold as the #875 (#820-828 couplers) or #1875 (1700 & 1800 series couplers) Knuckle Spring. The Knuckle Spring used on Kadee® G-Scale couplers are sold as the #860 Knuckle Spring.

For Delayed Action Uncoupling use our #842 Uncoupler, #844 Portable Uncoupler, or our #840 Uncoupler mounted in LGB track.

Kadee® coupler conversion list & coupler conversions are on the Kadee® web site for your convenience.

[www.kadee.com/conv/convpl.htm](http://www.kadee.com/conv/convpl.htm)

# MAGNE-MATIC®

**WARNING:**  
CHOKING HAZARD - Small Parts  
Not for children under 14 years.



Made & Assembled Entirely  
in the U.S.A.

## Kadee®

Quality Products Co.

673 Avenue C,  
White City, OR 97503-1078  
022309

© 2009, Kadee® Quality Products Co.