



# #241



"DUAL TOOL"

ONE EACH

## MANUAL UNCOUPLING TOOL

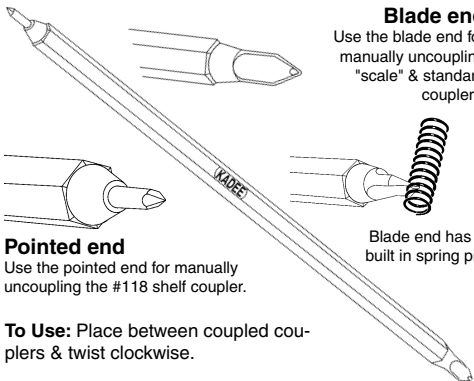

### Blade end

Use the blade end for manually uncoupling "scale" & standard couplers.

### Pointed end

Use the pointed end for manually uncoupling the #118 shelf coupler.

Blade end has a built in spring pic

**To Use:** Place between coupled couplers & twist clockwise.

All Kadee® products are Guaranteed\*

# Kadee®

Made Entirely  
in the U.S.A.



Quality Products Co.

673 Avenue C,  
White City, OR 97503-1078

©2009, Kadee® Quality Products Co.  
022309

**WARNING:**  
CHOKING HAZARD - Small Parts  
Not for children under 14 years.

