



#770 Truck Bolster Adapter

ASSEMBLY INSTRUCTIONS (guidelines)

BEFORE YOU BEGIN CAREFULLY READ THE INSTRUCTIONS AND STUDY THE ILLUSTRATIONS. Check the package contents and familiarize yourself with each part. If any parts are missing please contact Kadee® Quality Products using the Kadee® website.

PACKAGE CONTENTS: (2) bolster adapters, (4) bolster ends, (2) bolster mounts, (2) floor bushings, (4) 3-56 x 5/16 screws.

Modifications to car and/or mounting adapters may be required: O-Scale is the wild wild west. The only thing consistent with O-Scale is the lack of consistency. No "one" product can fix O-Scale's versions. We can only make things as close to the NMRA standards as we can. If a car was not built original to NMRA standards, then there is more custom modifications that will have to be preformed by the end user.

We will be covering common mounting using the bolster mount provided with the bolster adapters on metal stamped floors and plastic floor cars without a bolster molded on the underframe (Lionel, MTH, Rail King, K-Line, Williams, etc. cars). These Metal or plastic floor cars require the #770 bolster adapter or some sort of custom mounting platform to mount the trucks to the cars frame. The Kadee® #770 bolster adapter is designed to be a universal mounting platform for (Lionel, MTH, Rail King, K-Line, Williams, etc. cars) the bolster ends clip in to the bolster adapter and then can be filed to fit the floor width so the bolster is centered in the car. The floor will need to be

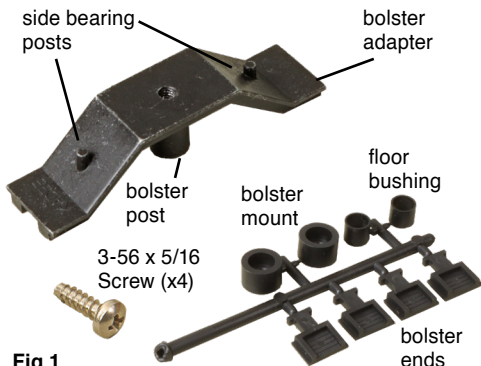

Fig 1

removed from the car and for final assembly of the bolster to the cars floor. The #770 adapter bolster with the bolster ends attached and fit to floor. The bolster post goes through the floor through the original truck mounting hole. The bolster mount then goes over the bolster post from the inside side of the floor attaching it with the 3-56 x 5/16 screw (See Fig 2). If the floor hole is to small to fit the bolster post though the car, drill the floor hole out using a 7/32 drill bit. If the bolster post is loose in the original floor hole you can use the optional floor bushing over the bolster post to tighten up the play in the hole in floor to bolster post, a little play will not affect mounting since the bolster mount will snug up and hold the bolster adapter in place once it is tightened.

Side bearing posts (anti rocking stops or bumpers): The Kadee® bolster adapters are equipped with side bearing posts (anti rocking stops or bumpers) on both bolster adapters. You only need to run one set of the side bearing posts (anti rocking stops or bumpers) you can remove one set if you don't want the side bearing posts (anti rocking stops or bumpers) on both ends of the car. File the side bearing posts or file the bolster bearing posts on the trucks can be filed down to "fine tune" the desired car rock on applicable cars with that feature.

Once Kadee trucks have been fitted to car, always check coupler height. Coupler height modification will probably be required due to non standardization in original equipment manufacturing in O-Scale. Always check coupler height and trip pin clearance using the #812 Kadee® O-Scale Coupler Height Gauge. If needed only use a Dry Graphite Lubricant such as our #231 "Greas-em" to lubricate the trucks, couplers or moving parts.

Disclaimer: These instructions are guidelines for adapting Kadee® all metal 2 piece trucks to O-Scale rolling stock. Some additional modifications may be required and there is no express warranty that Kadee® trucks will work in all applications.

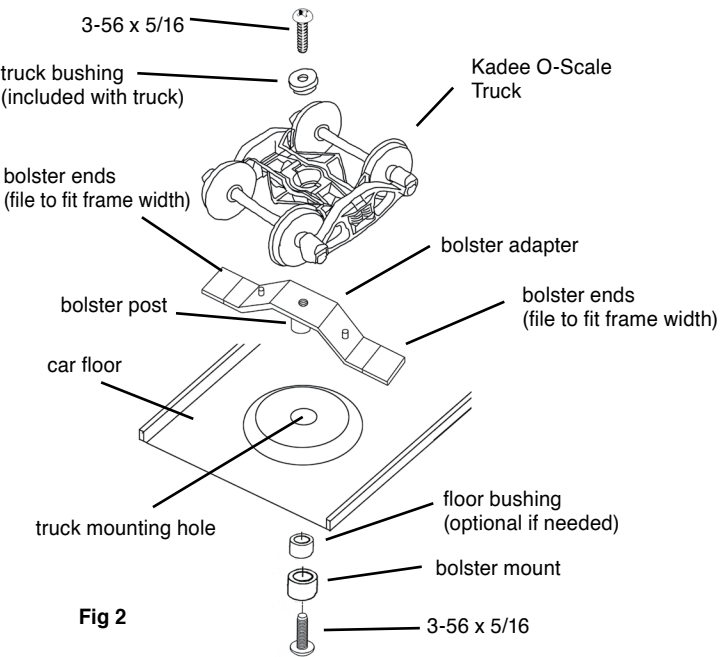
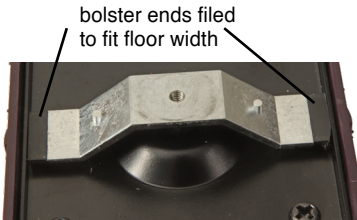
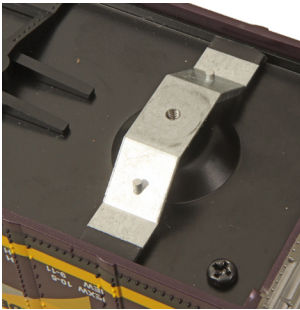

Fig 2



Bolster adapter attached to floor of car ready for trucks to be mounted (see Fig 2) to see how bolster adapter is attached to floor of car.



⚠ WARNING:
Cancer and Reproductive Harm - www.p65warnings.ca.gov
CHOKING HAZARD - Small Parts Not for children under 14 years.

091423

Kadee®

Quality Products Co.

**673 Avenue C,
White City, OR 97503-1078**

www.kadee.com



Made & Assembled Entirely
in the U.S.A.

© 2023, Kadee® Quality Products Co.